

J-Channel Back-Plate for Pilaster

- Provides a flat mounting surface for headers and pilasters
- Built-in J-Channel helps prevent water penetration
- Made in the USA
- Engineered and manufactured to exacting standards
- Will not crack, split, or fade
- Lightweight product
- This product qualifies for our Lowest Price Guarantee
- Order now and get our 30 day Price Protection

Item #: 00832696
List Price: \$72.27
\$52.37 (EACH)
Save \$19.90 (27%)

FREE Shipping!
Usually ships in 16-21 business days

MORE IMAGES

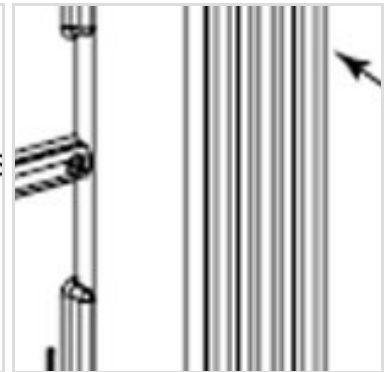
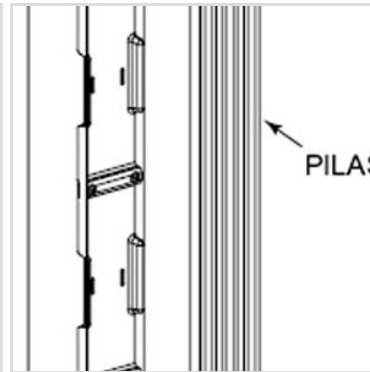
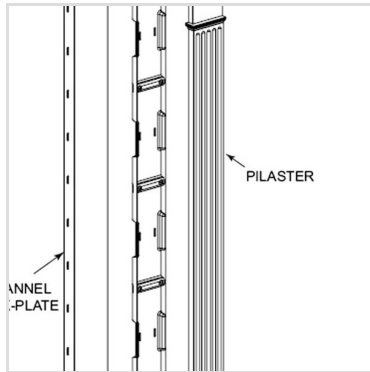
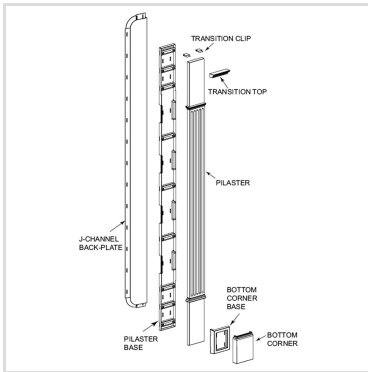

DESCRIPTION

Remodelers, builders, and homeowners looking to enhance their next project by adding more curb appeal to the exterior of a home should consider crossheads. Crossheads are large casings that are typically placed at the top of a window, doorway or large entryway. Made of lightweight, yet durable high-density polyurethane, crossheads are easy for anyone to install. Feel free to choose from an amazing selection of sizes and style that will suit your project needs.

Order online at: <https://www.architecturaldepot.com/00832696.html>

Date Printed: 03/28/2024 - 2:47 am